

99492

Dimensions

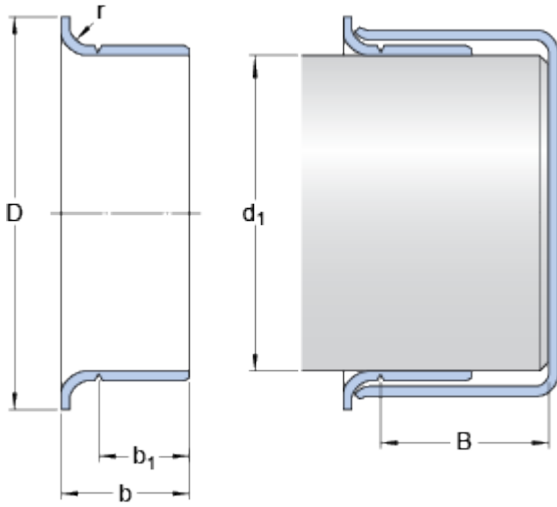

Nominal dimensions

d_1		125	mm
D		137.16	mm
Tolerance outside diameter D	\pm	1.6	mm
b		32.004	mm
Tolerance width b	\pm	0.8	mm
b_1		26.01	mm
Tolerance width b_1	\pm	0.8	mm
B	max.	36.525	mm
r	max.	3.18	mm

Shaft diameter range

d_1	min.	124.892	mm
d_1	max.	125.095	mm